

4100

Contropiastre ed accessori
Stricker plate and accessories

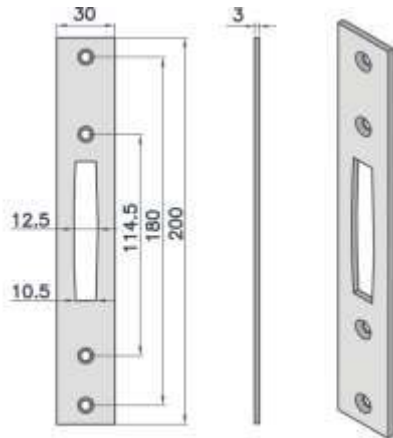

Contropiasta per serie 4000
Stricker plate for 4000 series

Codice	Finitura	Confezione
Code	Finishing	Packaging
4101	ZN	10
4102	INOX	10

1100

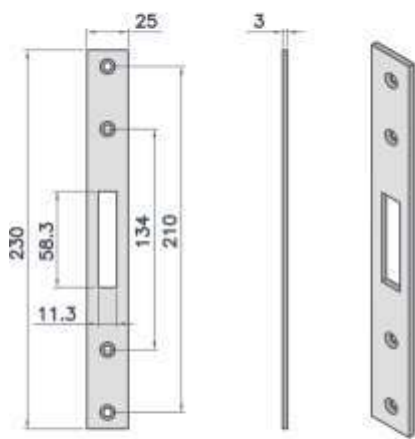

Contropiasta per serie 1000/3000
Stricker plate for 1000/3000 series

codice	finitura	confezione
code	finishing	packaging
1100	ZN	10

604

605

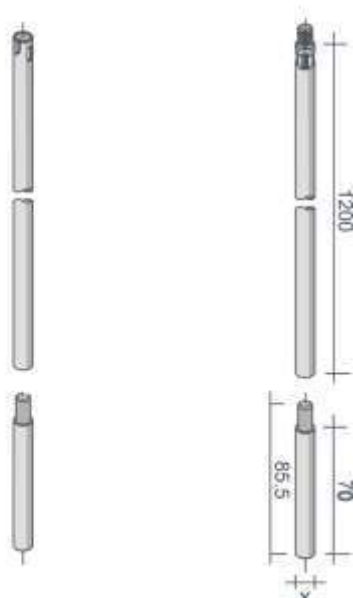

coppia aste e cancelletto
Pairs of bars for gates

Codice	Fissaggio	Finitura	Ø Perni	Confezione
Code	Fixing	Finishing	Ø Pins	Packaging
604/Z/10	asola/hole	NT	10	25
604/Z/12	asola/hole	NT	12	25
604/Z/14	asola/hole	NT	14	25
605/Z/10	Grano M8/Screw M8	ZN	10	25
605/Z/12	Grano M8/Screw M8	ZN	12	25
605/Z/14	Grano M8/Screw M8	ZN	14	25

1110

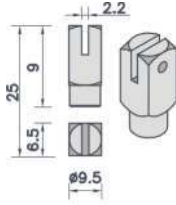

Boccola filettata M8
Threaded (M8) bushes

Codice	Finitura	Confezione
Code	Finishing	Packaging
1110	ZN	100

100



Chiave doppia mappa grezza
Double bit-key blank

Codice	Finitura	Confezione
Code	Finishing	Packaging
1000	NK	100

610-612-614

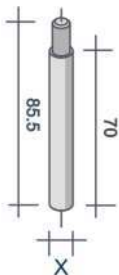

Perno terminale per asta cancelletto
Bolts for gate bars

Codice	Finitura	Ø	Confezione
Code	Finishing		Packaging
610Z	ZN	10	100
612Z	ZN	12	100
614Z	ZN	14	100

Tappi in nylon copri-lavorazione Nylon cover for bolt hole



Codice Code	Lunghezza X Length X	Confezioni Packaging
TAPPCO	32	500
TAPPLU	42	500

Lame parafreddo Nylon cover for bolt hole

CARATTERISTICHE TECNICHE:

- Movimento basculante frizionato
- Corsa 14 mm.
- Molle in acciaio zincato e bielle di spinta in PA 20% fibra di vetro
- Profili in alluminio in lega 6060 T6.
- Sfilabilità meccanismo lato cerniera dopo il fissaggio.

TECHNICAL CHARACTERISTICS:

- Graduated scissor action
- 14 mm. maximum drop.
- Galvanised steel flat springs and actuators in PA reinforced with 20% glassfibre..
- 6060 T6 aluminium alloy profiles.
- Mechanism removable from hinge side after fixing.

LPF/E

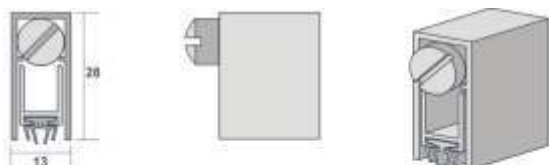

Codice Code	Lunghezza Length	Confezioni Packaging
LPF/E33	cm 33	5
LPF/E43	Cm 43	5
LPF/E53	Cm 53	5
LPF/E63	Cm 63	5
LPF/E73	Cm 73	5
LPF/E83	Cm 83	5
LPF/E93	Cm 93	5
LPF/E103	Cm 103	5
LPF/E113	Cm 113	5
LPF/E123	Cm 123	5

Pulsante in acciaio, regolabile con cacciavite a stella, taglio e con chiave fissa da 6 mm.
Steel plunger, adjustable with crosshead screwdriver, slotted screwdriver, and 6 mm spanner.

LPF/A

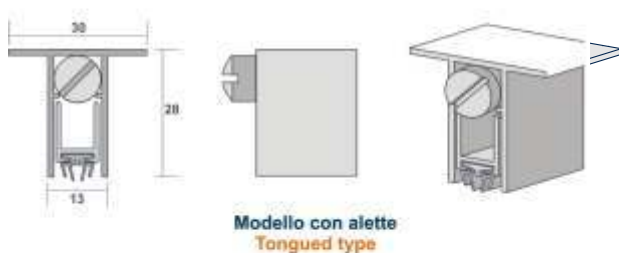

Codice Code	Lunghezza Length	Confezioni Packaging
LPF/A33	cm 33	5
LPF/A43	Cm 43	5
LPF/A53	Cm 53	5
LPF/A63	Cm 63	5
LPF/A73	Cm 73	5
LPF/A83	Cm 83	5
LPF/A93	Cm 93	5
LPF/A103	Cm 103	5
LPF/A113	Cm 113	5
LPF/A123	Cm 123	5

Pulsante in acciaio, regolabile con cacciavite a stella, taglio e con chiave fissa da 6 mm.
Steel plunger, adjustable with crosshead screwdriver, slotted screwdriver, and 6 mm spanner.

LPF/L

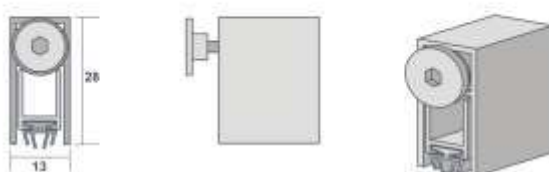

Codice Code	Lunghezza Length	Confezioni Packaging
LPF/L33	cm 33	5
LPF/L43	Cm 43	5
LPF/L53	Cm 53	5
LPF/L63	Cm 63	5
LPF/L73	Cm 73	5
LPF/L83	Cm 83	5
LPF/L93	Cm 93	5
LPF/L103	Cm 103	5
LPF/L113	Cm 113	5
LPF/L123	Cm 123	5

Pulsante autodirezionale snodato, metallico con cappuccio in Nylon regolabile con chiave esagonale da 3 mm.
Self-directing articulated metal plunger with nylon cap, adjustable with a 3 mm Allen wrench.